

TAPER GRID SPRING

TAPER GRID COUPLING

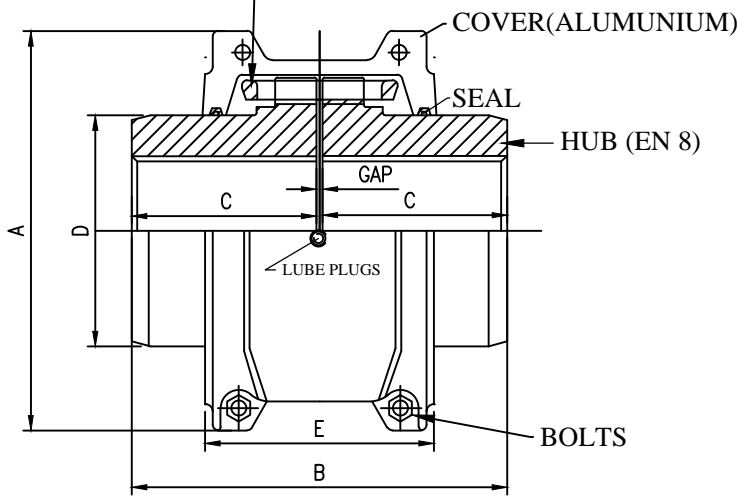

(WITH HORIZONTAL SPLIT ALLUMINIUM COVERS)

A TYPE

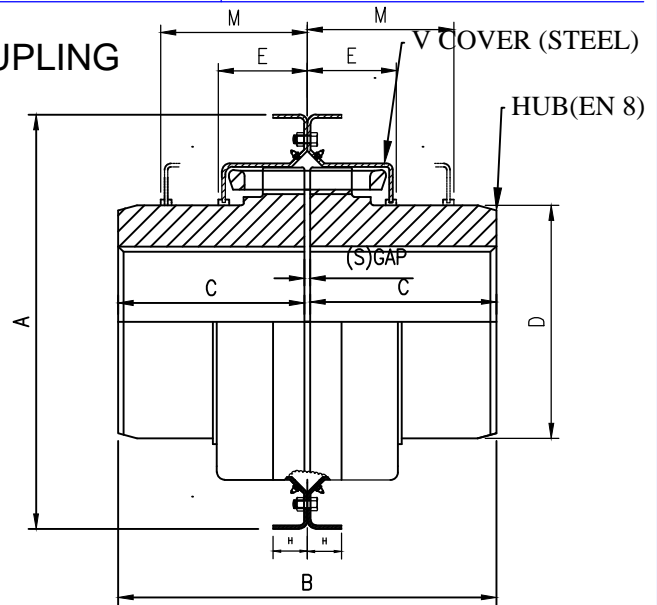

(WITH VERTICAL STEEL COVER)

V TYPE

ENGINEERING DATA

COUPLING SIZE	KW PER 100 RPM	MAX SPEED (RPM)		BASIC TORQUE(Nm)	BORE DIA (MM)		COUPLING WT(KG)		LUBE WT(KG)	EQUIVALENT SIZE
		A TYPE	V-TYPE		Max.	Min.	A TYPE	V-TYPE		
BRTC -1020T	0.55	4500	6000	48	30	12	1.9	2	0.03	1020
BRTC -1030T	1.58	4500	6000	134	36	12	2.6	2.6	0.03	1030
BRTC -1040T	2.65	4500	6000	219	44	12	3.4	3.4	0.05	1040
BRTC -1050T	4.60	4500	6000	391	51	12	5.4	5.4	0.05	1050
BRTC -1060T	7.30	4350	6000	620	57	19	7.3	7.3	0.09	1060
BRTC -1070T	10.40	4125	5500	897	68	19	10	10.4	0.11	1070
BRTC -1080T	21.90	3600	4750	1860	82	27	17	17.7	0.17	1080
BRTC -1090T	39.60	3600	4000	3339	95	27	25	25.4	0.25	1090
BRTC -1100T	66.70	2400	3250	5676	110	41	42	42.2	0.43	1100
BRTC -1110T	99.00	2250	3000	8395	120	41	54	54.4	0.51	1110
BRTC -1120T	145.80	2025	2700	12401	140	60	81	81.6	0.73	1120
BRTC -1130T	211.50	1800	2400	18030	170	67	121	122.5	0.91	1130
BRTC -1140T	301.00	1650	2200	25948	200	67	178	180.1	1.13	1140
BRTC -1150T	416.00	1500	2000	36155	215	108	234	230.0	1.95	1150
BRTC -1160T	586.00	1350	1750	50810	240	121	317	321.1	2.81	1160
BRTC -1170T	782.00	1225	1600	67746	280	133	448	448.2	3.49	1170
BRTC -1180T	1080.00	900	1400	93941	300	152	619	591.0	3.76	1180
BRTC -1190T	1430.00	820	1300	124201	335	152	776	761.0	4.40	1190
BRTC -1200T	1950.00	730	1100	169395	360	178	1058	1021.0	5.62	1200

ENGINEERING DATA (Vertical Split Cover & Horizontal split Cover)

COUPLING SIZE	A		B	C	D	E		GAP(mm)			Eqv Size
	A-Type	V-Type				A-Type	V-Type	Min	Normal	Max	
BRTC-1020T	101	111	98	47.5	39.7	66.5	24.2	1.5	3.0	4.5	1020
BRTC-1030T	110	121	98	47.5	49.2	68.3	25	1.5	3.0	4.5	1030
BRTC-1040T	117	128	104.6	50.8	57.1	70	25.7	1.5	3.0	4.5	1040
BRTC-1050T	138	148	123.6	60.3	66.7	79.5	31.2	1.5	3.0	4.5	1050
BRTC-1060T	150	162	130	63.5	76.2	92	32.2	1.5	3.0	4.5	1060
BRTC-1070T	161	173	155.4	76.2	87.3	95	33.7	1.5	3.0	4.5	1070
BRTC-1080T	194	200	180.8	88.9	105	116	44.2	1.5	3.0	4.5	1080
BRTC-1090T	213	232	199.8	98.4	124	122	47.7	1.5	3.0	6.0	1090
BRTC-1100T	250	267	245.7	120.6	142	155.5	60	1.5	3.0	6.0	1100
BRTC-1110T	270	286	258.5	127	160	161.5	64.2	1.5	4.5	9.5	1110
BRTC-1120T	308	319	304.4	149.2	179	191.5	73.4	1.5	4.5	9.5	1120
BRTC-1130T	346	378	329.8	161.9	218	195	75.1	1.5	6.0	12.5	1130
BRTC-1140T	384	416	371.6	182.8	254	201	78.2	1.5	6.0	12.5	1140
BRTC-1150T	453	476	372.0	182.8	269.2	271	107.0	1.5	6.0	12.5	1150
BRTC-1160T	501	533	402.0	198.0	304.8	279	114.5	1.5	6.0	12.5	1160
BRTC-1170T	566	584	438.0	216.0	355.6	304	120.0	1.5	6.0	12.5	1170
BRTC-1180T	630	630	483.5	239.0	393.7	321	130.0	1.5	6.0	12.5	1180
BRTC-1190T	675	685	524.0	260.0	436.9	325	135.0	1.5	6.0	12.5	1190
BRTC-1200T	757	737	565.0	279.5	497.8	355.5	145.0	1.5	6.0	12.5	1200

BOSON ENGINEERING
POWER TRANSMISSION EQUIPMENT

CONTACT US:

OFFICE : 4/19 G.T. ROAD (SOUTH) HOWRAH- 711101
MOBILE : 9830226942. PHONE : (033)2666 1263, FAX : (033)2666 2935,
e-mail : k.basu@bosonengg.com, website : www.bosonengg.com