

The ideal device for coupling Main and Auxiliary Motors to hoisting, steering and travelling motions. For Cranes, Hoist, Conveyors etc.

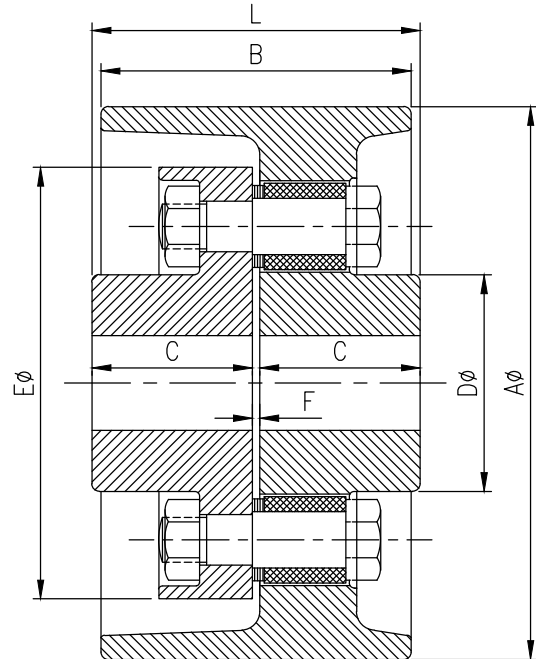

## Braking Torques, Maximum Speed And Dimensions

DRUM COUPLING DRUM DIA X FACE WIDTH		LOAD CAPACITY Torque in kgf-m   H.P.PER 100rpm		Max. R.P.M.	BORE		No. OF Pins	DIMENSION IN M.M.						
					Max.	Pilot		Aø	B	C	Dø	L	Eø	F
110	70	3.60	0.50	5750	20	10	3	100	70	38	45	72	95	2.0
150	85	23.00	3.20	3800	45	10	6	150	85	51	67	102.5	130	2.5
200	105	50.00	7.00	2850	50	15	4	200	105	51	75	123	160	3.0
250	115	143.20	20.00	2300	75	20	6	250	115	76	115	183	225	3.0
300	125	300.80	42.00	1900	90	30	12	300	125	89	140	183	254	3.0
380	175	480.00	67.00	1500	110	40	18	380	175	130	205	283	340	3.0
400	175	480.00	67.00	1400	110	40	12	400	175	135	212	283	360	3.0
500	210	930.00	129.00	1200	125	50	16	500	210	180	255	326	440	6.0
600	235	1253.00	175.00	950	140	50	20	600	235	200	285	346	530	6.0
750	275	1791.00	250.00	765	150	50	20	750	275	200	285	406	530	6.0

Combined Gear Coupling with brake drum also available.  
All dimensions are subjected to change without notice.

All dimensions are in mm.

**BOSON ENGINEERING**  
POWER TRANSMISSION EQUIPMENT  
Engineers & Manufacturers

CONTACT US:  
OFFICE : 4/19 G.T. ROAD (SOUTH) HOWRAH- 711101  
MOBILE : 9830226942. PHONE : 6291250277, 9830612043  
e-mail : k.basu@bosonengg.com, website : www.bosonengg.com